

# SWAUK RANCH CONSERVATION PLAT

IN SECTION 17 AND SECTION 20,  
TOWNSHIP 19 NORTH, RANGE 17 EAST, W.M.  
TAX PARCELS 207734

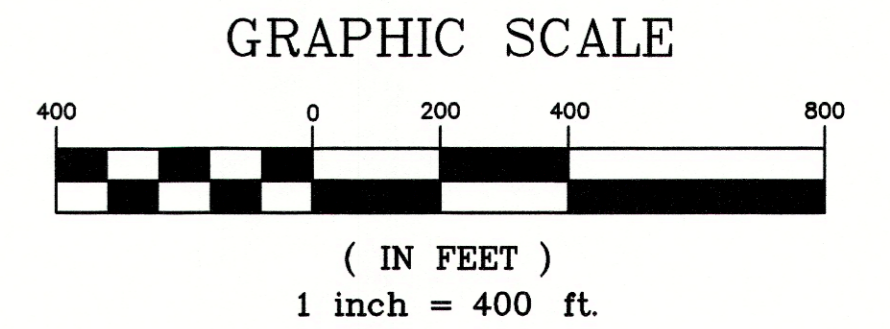
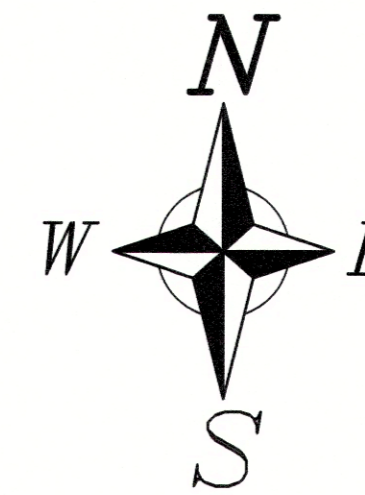

### LEGEND

- FOUND MONUMENT AS NOTED
- SET 5/8"X24" REBAR W/ PLASTIC CAP
- BASIS OF BEARINGS**  
SEE SHEET 3
- SURVEY REFERENCES**  
SEE SHEET 3

**MONUMENTS VISITED**  
JANUARY 2012-MARCH 2018  
**LEGAL DESCRIPTIONS**  
SEE SHEET 3

### OWNER/SUBDIVIDER

SWAUK VALLEY RANCH, LLC  
PO BOX 2457 (MAILING ADDRESS)  
SEATTLE, WA 98124  
18511 HWY 10 (PHYSICAL ADDRESS)  
ELLENSBURG, WA 98926

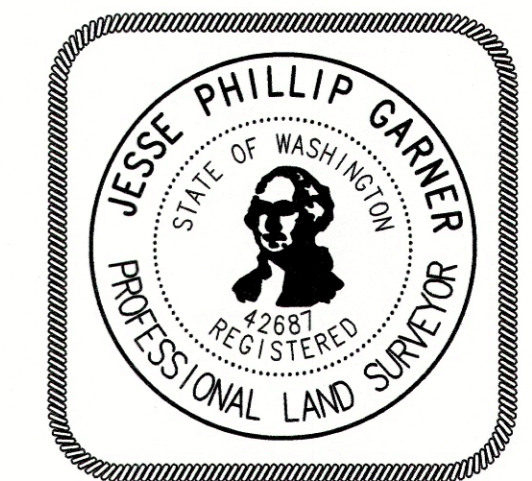

### Surveyor's Certificate

This Map correctly represents a Survey made by me or under my direction in conformance with the requirements of the Survey Recording Act at the request of

SWAUK VALLEY RANCH LLC in 08-16.

Jesse P. Garner, PLS 42687 Date \_\_\_\_\_

### Accuracy Statement (WAC 332-130)

This Survey was performed with a Topcon Hyper+ RTK surveying system with a relative accuracy greater than 1:5000. Mathematical analysis where required is by least squares.

### Note

No warranties are made as to matters of encroachment, adverse possession, unwritten title, riparian changes or flood zones, etc.

Date: 3-28-18

Scale: 1"=400'

Drawn By: JG

Surveyed By: JG/TB

Checked By: JG

Sheet 2 Of 3

Job Number: 2016-SWK

Survey For  
**SWAUK VALLEY RANCH, LLC.**  
Sections 17, 20, T. 19 N, R. 17 E, W.M.  
Kittitas County, Washington

**PSE Pioneer Surveying & Engineering, Inc.**  
Civil Engineering and Land Planning  
125 Simcoe Drive  
Goldendale, Washington 98620  
Phone (509) 773-4945, Fax (509) 773-5888, E-Mail pse@gorge.net

### Auditor's Certificate

Filed For Record This \_\_\_\_\_ Day of \_\_\_\_\_ 20\_\_\_\_.  
At \_\_\_\_\_ M.  
In Book \_\_\_\_\_ Of Surveys At Page \_\_\_\_\_  
At The Request Of Pioneer Surveying and Engineering, Inc.

KITTITAS COUNTY AUDITOR \_\_\_\_\_

DEPUTY COUNTY AUDITOR \_\_\_\_\_

LINE	LENGTH	BEARING
L1	319.62	S83°25'19"E
L2	50.00	S06°34'41"W
L3	43.40	S83°25'19"E
L4	20.00	N45°58'17"E
L5	81.73	S41°25'19"E
L6	274.88	N88°53'03"E
L7	289.22	S00°27'12"E
L8	177.48	S41°25'19"E
L9	20.00	N48°34'41"E
L10	404.10	S41°25'19"E
L11	20.00	S42°49'29"W
L12	40.00	S30°49'32"W
L13	489.80	S77°47'19"E
L14	50.00	N12°12'41"E
L15	373.80	S77°47'19"E
L16	52.37	S11°41'15"W
L17	59.78	S88°47'32"E
L18	92.79	N27°58'33"W
L19	200.00	N14°51'27"E
L20	146.00	N18°51'27"E
L21	177.00	N44°21'27"E
L22	266.00	S69°08'33"E
L23	336.89	S59°12'13"E
L24	201.70	S61°34'33"E
L25	231.68	S00°08'33"E

CURVE	LENGTH	RADIUS	CHORD	CHORD DIR
C1	690.98	1005.00	677.45	N63°43'31"W
C2	46.58	1025.00	46.58	N42°43'36"W
C3	84.85	845.00	84.82	S44°17'55"E
C4	181.15	865.00	180.82	S53°10'30"E
C5	293.96	905.00	292.67	S68°28'47"E
C6	25.29	2765.00	25.29	S78°03'02"E

**SHEET 2**